



Innovative conveyor systems
in modular design.





Innovative conveyor systems made in Hoerstel, Germany.

Back in 1995 VHV Anlagenbau GmbH was founded by the three managing directors Bernhard Veltmann, Georg Hagemann and Bernhard Verlage. The idea of innovative conveyor technology has been the basis of our success on the national and international market until today.

In all areas of the belt conveyor technology, the innovative steep incline conveyor systems in particular, we are one of the market leaders. Our systems are now in use in virtually all industries that need to move bulk materials such as stone, minerals and ceramics. Our patent-registered steep incline conveyor systems enable a vertical conveyance using smooth belts.

The success of these belt conveyor systems results from the economical and flexible applications they offer our customers. Our innovative conveyor systems offer tailor-made solutions within a space-saving design while keeping our customers' production facilities both neat and tidy.

From single systems to entire plants, we support our customers from the start to achieve designs that are exceptionally efficient. Contact us now to learn more about our impressive reference projects.





What we can do for you. Learn about our reference projects.

Our core business: The planning and construction of made-to-measure conveyor systems. Throughout the services we offer, you benefit from the long experience of our skilled team. As a mid-sized company, we have the ability to implement your order rapidly and to your exact requirements.

Our broad service portfolio includes a full set of consulting and planning services utilizing professional 3D laser scanning as well as the installation and setup of your specific system. We use only the highest quality materials for your project plus the very latest technologies and a team of highly qualified employees specializing in custom systems.

We give you full support in each project phase and our professional project management team ensures reliable planning every step of the way. The result is a completed conveyor system that is designed and built to your exact requirements. Efficient and durable.



*Tailor-made solutions:
We develop customer-specific solutions.*

We draw on our many years of experience to design made-to-measure plans and projects. The most modern 3D laser scanning measures installation scenarios down to the last millimeter to ensure plans that guarantee an optimum use of space. This range of options also ensures that we can take existing machine pools into account in our three-dimensional drawings and develop ideal solutions for a very wide range of industries.

Get to know our range of services by having a closer look at the Job Reports you can find on our website.

*Huge vertical integration – one stop:
Turning, lasering, edging, welding, vulcanizing.*

As a manufacturer we attach great importance to a huge vertical integration, meaning that one can find extensive and modern machinery for the internal machining, sheet metal forming, steel manufacture and the vulcanization department on VHV's premises. Our high-skilled employees are able to implement our customer's requests both flexibly and rapidly, guaranteeing high quality standards for all products manufactured at VHV Anlagenbau.

*We work for you:
Let our assembly team take care of it.*

To make optimum use of our machines and systems we offer a comprehensive range of assembly and commissioning services. Our assembly team travels all around the world to ensure the professional installation of VHV's machinery. To secure trouble-free operation well beyond the initial installation date, it is important to us that your operating personnel receives a comprehensive course of training in the new system. We naturally also offer maintenance and requirements analysis as well as an extensive spare parts service.





Testing, researching and finding solutions: **This is our pilot plant.**

To get an overview of our product portfolio – and our patented systems for steep incline conveyor systems in particular – just send us a material sample and we will arrange a personal test run for you on our premises. By testing under real-world conditions in this way, we can see how the machinery and materials behave in the various test systems from VHV.

Our pilot plant serves as a platform for our R&D work since it enables immediate testing for our innovations. Learn more about the opportunities, machinery and systems offered by our pilot plant. As one example, we can demonstrate various inclines for cover belt conveyors with smooth belts.

Our pilot plant machine pool:

- ✓ Double belt conveyor
- ✓ Cover belt conveyor
- ✓ Scraper plow
- ✓ Box feeder and discharge belt
- ✓ VHV's scraper systems
- ✓ VHV's synchro material distributor
- ✓ Various rack types

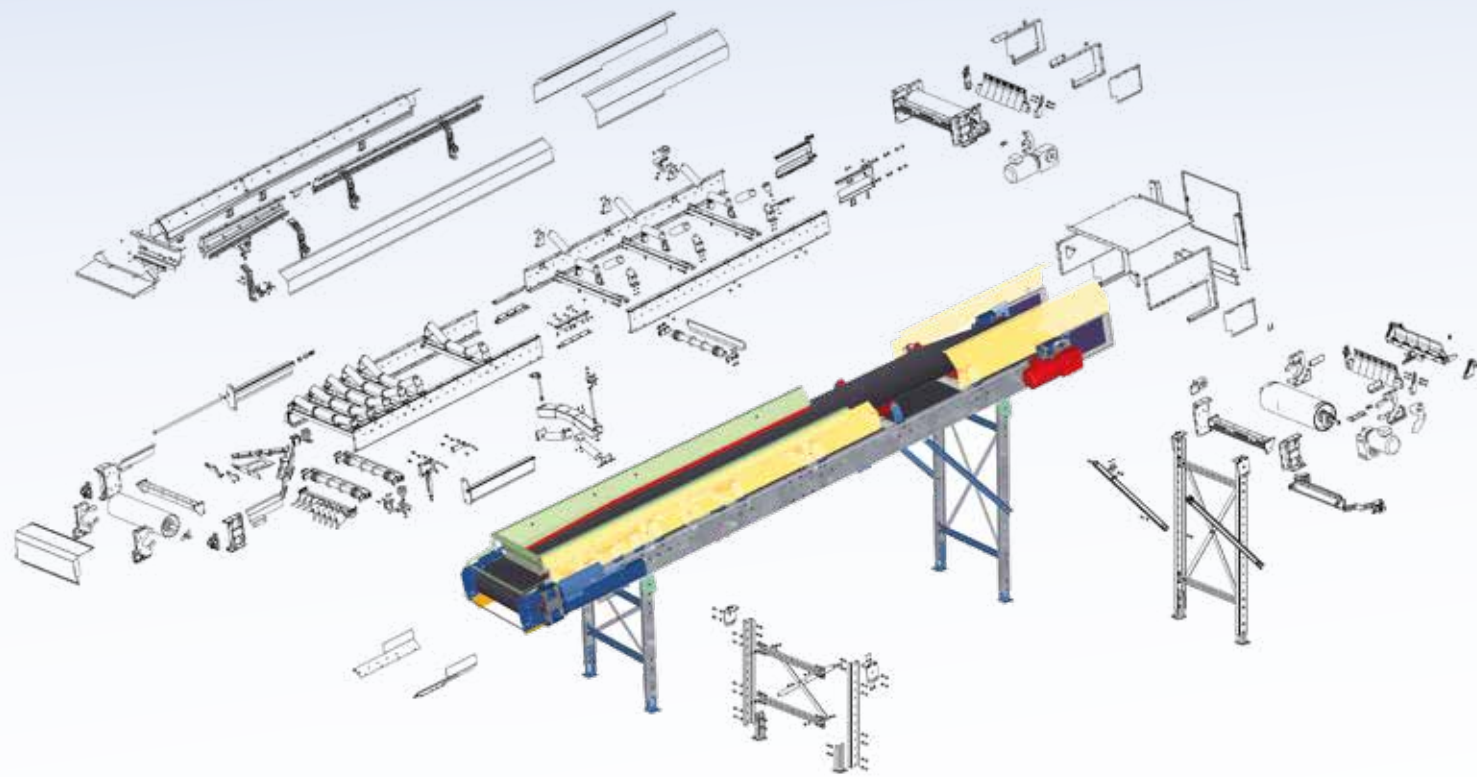

Discover the possibilities offered by VHV's modular system.



Our products are based on precise, modular and flexible system components.

- ✓ Optimal use of space thanks to compact module heights and lengths
- ✓ Modular and flexible design
- ✓ CNC manufacturing ensures high production accuracy
- ✓ Practical choice of dimensions for all component parts
- ✓ Easy to modify and expand
- ✓ Easy to assemble and maintain
- ✓ Long-term availability and reliability
- ✓ Compatibility with standard industry parts and applications

Turn, move and swivel. Distribute, dose and weigh. Our belt conveyor is suitable for a wide range of applications.

Thanks to the modularity offered by our products, our machines can be used for a very wide range of applications. Based on our modular system and flexibly usable components, our machines offer a whole series of advantages even if there is only limited space.



VHV's steep incline conveying technology

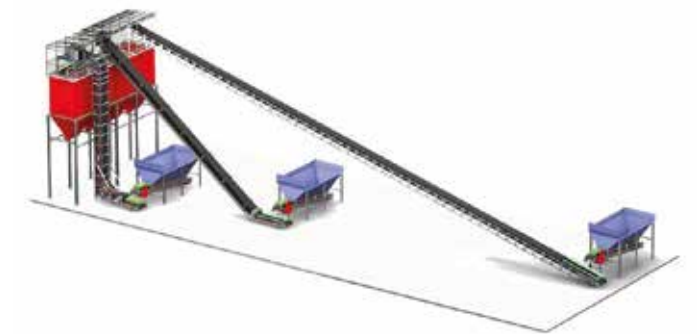

Space-saving and innovative: Discover the possibilities offered by our steep incline conveying technology.

To ensure we can offer a space-saving solution for conveying materials even in difficult installation scenarios, we developed both VHV's double belt conveyor and VHV's cover belt conveyor which feature our patented conveying technology. Both systems offer a wide range of options and advantages:

Classic ...

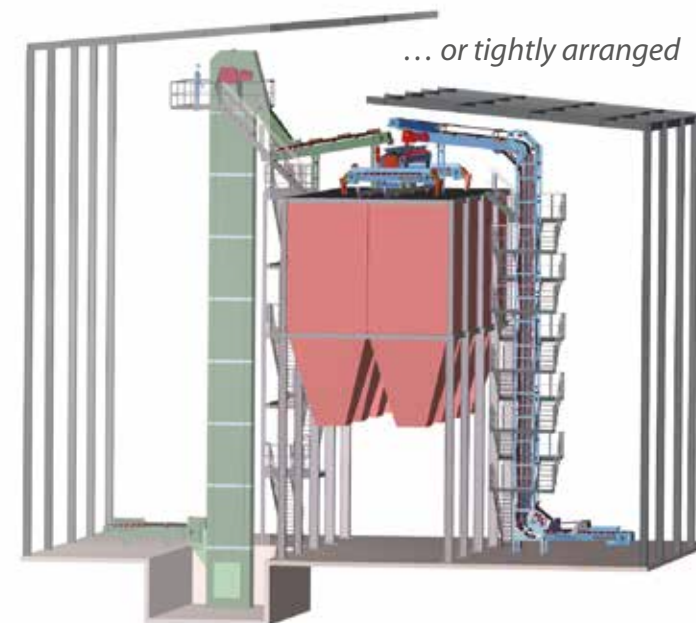

... or tightly arranged

VHV's double belt conveyor replaces: The infeed belt, bucket elevator, connecting conveyor, stair tower, basement deepening as well as the raise of the roof.

- ✓ **Clean** – thanks to scrapers on smooth belts
- ✓ **Unmixed** – since no material deposits can accumulate
- ✓ **Space-saving** – no additional transfer points, basement pits or roof structures
- ✓ **Continuous** – since no abrupt discharge system by using buckets or pouches
- ✓ **Low-wear** – since the material conveyed is set down and does not need to be scooped
- ✓ **Low follow-up costs** – since standard, commercially-available smooth belts are used, neither buckets nor pouches are necessary
- ✓ **Flexible layout of the line** – since lines can be routed in a very wide range of configurations
- ✓ **Modular expansion** – VHV's double and cover belt conveyor can be expanded with the following component parts (for instance):
 - ✓ Adjustable idler distances for clamp and seal systems
 - ✓ Stairs, walkways and platforms
 - ✓ Spillage return systems
 - ✓ Delivery hoods, chutes etc.
 - ✓ Rain cover
 - ✓ And much more ...



VHV's scraper systems

VHV's diverse scraper systems

To ensure an optimal cleaning of smooth belts both for indoor and outdoor applications, our product portfolio also offers a range of VHV scraper systems. Contact us in order to find out more about the ideal scraper system for your application.



Further ancillary equipment

Thanks to our modular design, we can equip our machines with a wide range of additional equipment such as follows:

- ✓ Catwalks, stairs and ladders
- ✓ Hoppers for spillage
- ✓ Rain covers
- ✓ Chutes
- ✓ Belt scales
- ✓ Metal detectors
- ✓ Magnet systems
- ✓ Belt deflector units
- ✓ Baffle plates
- ✓ Impact mats and damping elements
- ✓ Electrical accessories such as fill sensors or material flow controls
- ✓ Synchro material distributors to ensure an even material stream



Further innovative machinery.

VHV's dosing and weighing systems

Dosing here means the uniform discharge of bulk materials and can be offered as a continuous or batch process. From the smallest dosing belt, pushers or flaps to heavy-duty discharge belts and box feeders – discover the many benefits offered by our systems.

Box feeders and hopper discharge belt conveyors

- ✓ A hopper system featuring per-segment screwed sections avoids expensive welded designs
- ✓ Hopper dimensions, lateral inclinations and discharge forces are designed to match your product
- ✓ Conveyor performance can be adjusted with speed controls and layer heights
- ✓ Practical choice of drive sizes
- ✓ We can also supply additional equipment such as coilers, mandrels, liners, folding covers and grating covers

Dosing belt conveyors

- ✓ Compact system design
- ✓ Scraper systems for your specific application
- ✓ Sliding gates as shut-off spindle gate or push gate
- ✓ Height-adjustable control gate
- ✓ Various types of liner
- ✓ Scales: Dosing belt scales, built-in belt scales, batch weighing (static, continuous, calibratable)

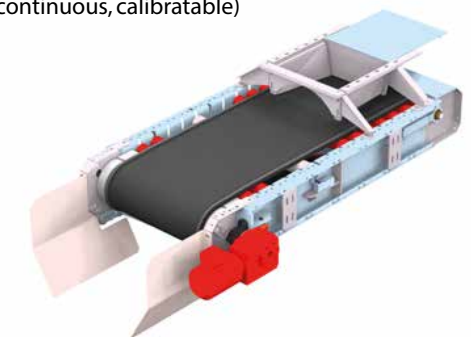

VHV's FlatFeeder for bulk freight

- ✓ Direct loading by using truck / articulated truck, wheel loader or excavator
- ✓ Buffer volume of approx. 22 m³
- ✓ Regulated discharge incl. adjustable conveying capacity
- ✓ Feasible conveying capacities of 40 m³/h up to over 400 m³/h
- ✓ Height offset only 1,500 mm by deepening or ramp
- ✓ Protective grating partially accessible by vehicle
- ✓ Correctly sorted discharging due to greatly efficient vibrator technology at gratings and walls
- ✓ Comparably little noise emission





VHV is the name of trust in a wide range of industries.

Our long experience, highly qualified employees and the constant improvements made to our systems offer a steady stream of new product innovations. Our systems have been used worldwide by many different businesses in the industry for bulk freight and piece goods.



- ✓ Ceramic industry
- ✓ Foundries
- ✓ Quarries
- ✓ Concrete industry
- ✓ Sand/gravel plants
- ✓ Recycling facilities
- ✓ Chemical industry
- ✓ Industry for cement / lime / gypsum
- ✓ Sand-lime brick
- ✓ Wood/paper
- ✓ Power stations
- ✓ Iron and steel industry
- ✓ Biogas plants
- ✓ and much, much more...

First picture: Bent belt conveyor
Second picture: VHV's polygon screen



We support high potentials! But do not just take our word for it.

As an international manufacturer of belt conveyor systems, we naturally believe in the importance of being able to design and manufacture high-quality products with a highly motivated team.

As an employer and vocational training company we feel responsible for ensuring our employees enjoy the best possible conditions in their day-to-day work. This not only means the physical working environment we offer, but also extends to the individual options for personal development at our company. Whatever our individual backgrounds – business, technology or machinery – we believe that the mutual respect and a level playing field are essential to ensure successful teamwork and the success of our systems. Our innovative solutions and products have resulted from our openness to new ideas, our management style and the down-to-earth approach typical to the traditional skilled trades.

- ✓ Opportunities for further training
- ✓ Annual employee appraisal meetings
- ✓ Company suggestion schemes
- ✓ Support for occupational pension planning
- ✓ Modern machine/vehicle pools
- ✓ Ergonomic workspaces
- ✓ Business bike
- ✓ Individual training programmes
- ✓ In-house Training Workshop
- ✓ Annual company events



Economics, social affairs and ecology. **Quality is our priority** – throughout the entire company.

As a forward-thinking company we always strive to improve our products and services in these three areas as well.

We consider quality to mean the quality present in all our production units – not just the physical quality of the final product. The success of our business activities depends heavily on quality and the environment. In addition to the management of resources, social and ecology-minded commitment is of huge importance to us. This is the reason for us to support ecological and social facilities and projects in our area.



- ✓ Efficiency in all areas
- ✓ Modern machinery and car pool
- ✓ Long service life for our systems
- ✓ Regular audits of production-related energy consumption
- ✓ Regular checks of production-related raw material usage
- ✓ Compliance with high occupational safety and health standards
- ✓ Good working conditions
- ✓ Certified quality management system according to DIN EN ISO 9001





www.vhv-anlagenbau.de

www.facebook.com/VHVANlagenbau



VHV Anlagenbau GmbH

Dornierstraße 9 · 48477 Hoerstel · Germany

Phone: +49 (0)54 59/93 38-0 · Fax: +49 (0)54 59/93 38-80

E-Mail: info@vhv-anlagenbau.de

